



0 10

Catalog Series	Unique Features	Material	Bore	Pages
 <b>S57PY5MSU...</b>	Single, Miniature, Zero Backlash	303 Stainless Steel Body, 440 Stainless Steel Balls	Solid 2.5 to 6	7-4
 <b>S57PY5MDU...</b>	Double, Miniature, Zero Backlash	303 Stainless Steel Body, 440 Stainless Steel Balls	2.5 to 6	7-4
 <b>S57PY4MSFU...</b>	Single, Inverted Design, Zero Backlash	303 Stainless Steel Body, 440 Stainless Steel Balls	5 to 14	7-5
 <b>S57PY4MDFU...</b>	Double, Inverted Design, Zero Backlash	303 Stainless Steel Body, 440 Stainless Steel Balls	5 to 14	7-5
 <b>A 5Y 8MDM...</b>	Single, Short Series, Solid and Bored	303 Stainless Steel	Solid 6 to 12	7-6
 <b>A 5Y 8MDU...</b>	Single, Step Down Series	303 Stainless Steel	3 to 6	7-6
 <b>A 5Q 8MD...</b>	Single, Standard Design, Solid and Bored	Alloy Steel	Solid 4 to 14	7-7
 <b>A 5Y 8MDGZ...</b>	Single, Small Series	303 Stainless Steel	3 to 5	7-8



0 10

- I
- R
- T
- 1
- 2
- 3
- 4
- 5
- 6
- 7**
- 8
- 9
- 10
- 11
- 12
- 13
- 14
- 15
- A

Catalog Series	Unique Features	Material	Bore	Pages
 <b>A 5Q 8MDGZ...</b>	Single, Small Series	4140 Alloy Steel	3 to 5	7-8
 <b>A 5Q 8MDM...</b>	Single, Solid and Bored	Alloy Steel	Solid 6 to 12	7-8
 <b>A 5Q 8MDD...</b>	Double, Slow Speed	Alloy Steel	Solid 4 to 14	7-9
 <b>A 5Q 8MDG...</b>	Double	Carbon Steel Unhardened	6 to 20	7-10
 <b>A 5X 8MSE...</b>	Double, Telescoping, Heat- and Corrosion-Resistant	300 Series SS Joints, 416 Stainless Steel Spline	6 to 14	7-11
 <b>S57PY5MDUT...</b>	Double, Telescoping, Miniature, Ball Spline, Zero Backlash	303 Stainless Steel Body, 440 Stainless Steel Balls	2.5 to 6	7-12
 <b>S57PY4MDFUT...</b>	Double, Telescoping, Inverted Design, Ball Spline, Zero Backlash	440 Stainless Steel Body, 440 Stainless Steel Balls	5 to 14	7-12



0 10

Catalog Series	Unique Features	Material	Bore	Pages
 <b>A 5M 8MD...</b>	Single, Molded, Economy Series	Acetal	3 to 10	7-14
 <b>A 5M 8MDD...</b>	Double, Molded, Economy Series	Acetal	3 to 10	7-14
 <b>A 5T 8MD...</b>	Single, Molded, Brass Spider	Acetal Body, Brass Spider	3 to 10	7-15
 <b>A 5Z 8MD...</b>	Single, Molded, Brass Spider & Inserts	Acetal Body, Brass Spider & Inserts	2 to 8	7-15
 <b>A 5T 8MDD...</b>	Double, Molded, Brass Spider	Acetal Body, Brass Spider	3 to 10	7-16
 <b>A 5Z 8MDD...</b>	Double, Molded, Brass Spider and Inserts	Acetal Body, Brass Spider and Inserts	2 to 8	7-16
 <b>A 5M 8MSE...</b>	Double, Telescoping, Molded, Economy Series	Acetal	4, 6, 8	7-17
 <b>A 5T 8MSE3...</b>	Double, Telescoping, Molded, Brass Spider, 9.5 O.D.	Acetal Body & Extension, Brass Spider	4, 6	7-18



Catalog Series	Unique Features	Material	Bore	Pages
 <b>A 5Z 8MSE3...</b>	Double, Telescoping, Molded, Brass Spider and inserts, 9.5 O.D.	Acetal Body and Extension, Brass Spider and Inserts	3, 4	7-18
 <b>A 5T 8MSE4...</b>	Double, Telescoping, Molded, Brass Spider, 12.7 O.D.	Acetal Body and Extension, Brass Spider	6, 8	7-19
 <b>A 5Z 8MSE4...</b>	Double, Telescoping, Molded, Brass Spider and Inserts, 12.7 O.D.	Acetal Body and Extension, Brass Spider and Inserts	4, 6	7-19
 <b>A 5Z 8MSEB...</b>	Double, Telescoping, Molded, Brass Spider Inserts and Extension	Acetal Body, Brass Spider, Inserts and Extension	2 to 8	7-20

- I
- R
- T
- 1
- 2
- 3
- 4
- 5
- 6
- 7**
- 8
- 9
- 10
- 11
- 12
- 13
- 14
- 15
- A

Stock Drive Products pioneered the concept of combining the exceptional qualities of selected plastic materials with different metals to create products which incorporate both.



SUPER-PLAST® designs have the following advantages:

1. Inexpensive replacement of metal components, particularly for low torque applications.
2. As vibration dampers due to the resiliency of plastics used.
3. For drives used in corrosive environments or for chemical processing equipment.
4. For drives which have to be electrically insulated.
5. For domestic appliances and other intermittent duty applications.



The SDP line of molded universal joints is a valuable extension of the above capabilities, and they are shown on the following pages:

Name	Description	Metric Series	Page
Universal Single Joint	All Molded	<b>A 5M 8MD...</b>	7-14
	Metal Spider (No Insert)	<b>A 5T 8MD...</b>	7-15
	Metal Spider and Insert	<b>A 5Z 8MD...</b>	7-15
Universal Double Joint	All Molded	<b>A 5M 8MDD...</b>	7-14
	Metal Spider (No Insert)	<b>A 5T 8MDD...</b>	7-16
	Metal Spider and Insert	<b>A 5Z 8MDD...</b>	7-16
Universal With Molded Slide Extension	All Molded	<b>A 5M 8MSE...</b>	7-17
	Metal Spider (No Insert)	<b>A 5T 8MSE...</b>	7-18, 7-19
	Metal Spider and Insert	<b>A 5Z 8MSE...</b>	7-18, 7-19
Universal With Brass Slide Extension	Metal Spider and Insert	<b>A 5Z 8MSEB...</b>	7-20

The above products are available from stock in standard configurations as presented in the catalog pages. They can also be manufactured to special requirements, with partial modification of existing tools. These "specials" can consist of:

- a) Bores molded to accommodate square, "D" shape or hexagonal shafts.
- b) Shafts molded into the components themselves.
- c) Zero backlash or components with built-in backlash.
- d) Gears, pulleys or other components molded or assembled to couplings or universal joints.

For inch size Molded Universal Joint series, see our Web site [www.sdp-si.com](http://www.sdp-si.com) or see our *Handbook of Inch Drive Components*.

Please consult SDP Application Engineering for further details.

# MOLDED UNIVERSAL JOINTS

# SDP/SI

SINGLE & DOUBLE JOINT  
ECONOMY SERIES

PHONE: 516.328.3300 • FAX: 516.326.8827 • WWW.SDP-SI.COM

**> MATERIAL:**

Body & Spider - Molded Acetal

**> MAX. OPERATING TEMPERATURE:**

+85°C

**> SPECIFICATIONS:**

Max. Angular Displacement - Fig. 1: 45°

Fig. 2: 90°

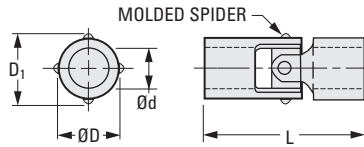

Fig. 1

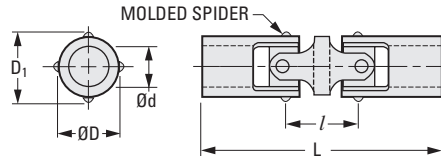

Fig. 2

## METRIC COMPONENT

Catalog Number	D Dia.	d Bore 0 -0.05	Bore Depth (Typ)	L Overall Length	D <sub>1</sub>	l	Max. Torque N • m	Max. Parallel Offset
<b>Fig. 1 Single Joint</b>								
A 5M 8MD203	6.3	3	5.8	19	6.6	-	0.2	-
A 5M 8MD204		4						
A 5M 8MD304	9.5	4	8.6	28.6	10.6	-	0.9	-
A 5M 8MD306		6						
A 5M 8MD406	12.7	6	10.6	35.6	13.8	-	2	-
A 5M 8MD408		8						
A 5M 8MD506	15.9	6	14.7	52.7	16.4	-	4.2	-
A 5M 8MD508		8						
A 5M 8MD510		10						
<b>Fig. 2 Double Joint</b>								
A 5M 8MDD203	6.3	3	5.8	27	6.6	8	0.2	0.22
A 5M 8MDD204		4						
A 5M 8MDD304	9.5	4	8.6	41.9	10.6	13.3	0.7	0.36
A 5M 8MDD306		6						
A 5M 8MDD406	12.7	6	10.6	51.3	13.8	15.7	1.2	0.43
A 5M 8MDD408		8						
A 5M 8MDD506	15.9	6	14.7	74.9	16.4	22.3	3.6	0.61
A 5M 8MDD508		8						
A 5M 8MDD510		10						

ELECTRICALLY INSULATING

PHONE: 516.328.3300 • FAX: 516.326.8827 • WWW.SDP-SI.COM

> **MATERIAL:**

Body - Molded Acetal  
Spider & Insert - Nickel Plated Brass

> **MAX. OPERATING TEMPERATURE:**

+85°C

> **SPECIFICATION:**

Max. Angular Displacement: 45°

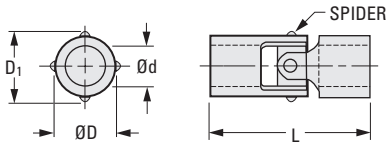
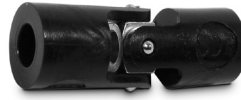

Fig. 1 Plain

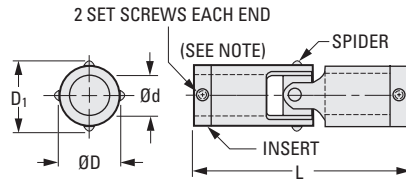

Fig. 2 With Insert

**METRIC COMPONENT**

Catalog Number	D Dia.	d Bore 0 -0.05	Bore Depth (Typ)	L Overall Length	D <sub>1</sub>	Set Screw	Max. Torque N • m
<b>Fig. 1 Plain</b>							
A 5T 8MD203	6.3	3	5.8	19	6.9	—	0.57
A 5T 8MD204	6.3	4	5.8	19	6.9	—	0.57
A 5T 8MD304	9.5	4	8.6	28.6	10.4	—	1.8
A 5T 8MD306	9.5	6	8.6	28.6	10.4	—	1.8
A 5T 8MD406	12.7	6	10.6	35.6	13.8	—	2.9
A 5T 8MD408	12.7	8	10.6	35.6	13.8	—	2.9
A 5T 8MD506	15.9	6	14.7	52.7	17	—	6.8
A 5T 8MD508	15.9	8	14.7	52.7	17	—	6.8
A 5T 8MD510	15.9	10	14.7	52.7	17	—	6.8
<b>Fig. 2 With Insert</b>							
A 5Z 8MD202	6.3	*2	9.9	26.6	6.9	M3	0.57
A 5Z 8MD203	6.3	*3	9.9	26.6	6.9	M3	0.57
A 5Z 8MD303	9.5	*3	13.2	37.5	10.4	M3	1.8
A 5Z 8MD304	9.5	4	13.2	37.5	10.4	M3	1.8
A 5Z 8MD404	12.7	*4	16	46.1	13.8	M3	2.9
A 5Z 8MD406	12.7	6	16	46.1	13.8	M3	2.9
A 5Z 8MD506	15.9	6	21.8	66.9	17	M4	6.8
A 5Z 8MD508	15.9	8	21.8	66.9	17	M4	6.8

\*NOTE: One set screw each end.

ELECTRICALLY INSULATING

PHONE: 516.328.3300 • FAX: 516.326.8827 • WWW.SDP-SI.COM

**> MATERIAL:**

Body - Molded Acetal  
Spider & Insert - Nickel Plated Brass

**> MAX. OPERATING TEMPERATURE:**

+85°C

**> SPECIFICATIONS:**

Max. Angular Displacement: 90°

d Bore Tolerance:

Fig. 1 Plain: 0/-0.05

Fig. 2 With Insert: +0.025/0

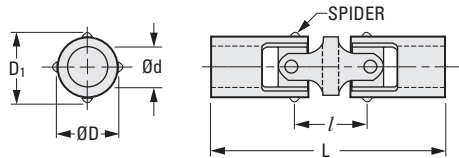
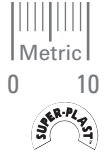

Fig. 1 Plain

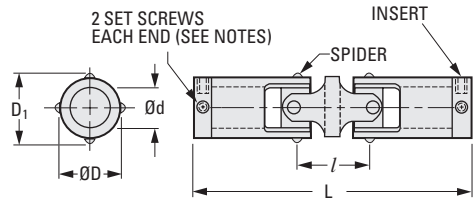

Fig. 2 With Insert

**METRIC COMPONENT**

Catalog Number	D Dia.	d Bore	Bore Depth (Typ)	L Overall Length	D <sub>1</sub>	l	Set Screw	Max. Torque N•m	Max. Parallel Offset
<b>Fig. 1 Plain</b>									
A 5T 8MDD203	6.3	3	5.8	27	6.9	8	—	0.3	5.6
A 5T 8MDD204	6.3	4	5.8	27	6.9	8	—	0.3	5.6
A 5T 8MDD304	9.5	4	8.6	41.9	10.4	13.3	—	0.8	9.1
A 5T 8MDD306	9.5	6	8.6	41.9	10.4	13.3	—	0.8	9.1
A 5T 8MDD406	12.7	6	10.6	51.3	13.8	15.7	—	1.4	10.9
A 5T 8MDD408	12.7	8	10.6	51.3	13.8	15.7	—	1.4	10.9
A 5T 8MDD506	15.9	6	14.7	74.9	17	22.3	—	5.3	15.5
A 5T 8MDD508	15.9	8	14.7	74.9	17	22.3	—	5.3	15.5
A 5T 8MDD510	15.9	10	14.7	74.9	17	22.3	—	5.3	15.5
<b>Fig. 2 With Insert</b>									
A 5Z 8MDD202	6.3	*2	9.9	34.6	6.9	8	M3	0.3	5.6
A 5Z 8MDD203	6.3	*3	9.9	34.6	6.9	8	M3	0.3	5.6
A 5Z 8MDD303	9.5	*3	13.2	50.8	10.4	13.3	M3	0.8	9.1
A 5Z 8MDD304	9.5	4	13.2	50.8	10.4	13.3	M3	0.8	9.1
A 5Z 8MDD404	12.7	*4	16	61.8	13.8	15.7	M3	1.4	10.9
A 5Z 8MDD406	12.7	6	16	61.8	13.8	15.7	M3	1.4	10.9
A 5Z 8MDD506	15.9	6	21.8	89.2	17	22.3	M4	5.3	15.5
A 5Z 8MDD508	15.9	8	21.8	89.2	17	22.3	M4	5.3	15.5

\*NOTE: One set screw each end.