







Catalog Series	Material	Hardness	Diameter in.	Length in.	Pages
 S4008Y-US1-.. S4012Y-US2-.. S4016Y-US3-..	303 Stainless Steel, Ultraprecision Ground	—	.12475 .18725 .24975	1 to 10	3-3
 S40PX0-HG...	416 Stainless Steel, Cond. T, Hardened & Ground	Rc 26 - 32	.1247 .1872 .2497 .3747	1 to 24	3-4 & 3-5
 S40PH0-CHS...	AISI C 1060 Steel, Hardened & Ground	Case Hardened to Rc 60 - 63	.2500 .3750 .5000	3 to 36	3-6
 S40PX0-CHS...	420 Stainless Steel, Hardened & Ground	Case Hardened to Rc 52 - 56	.3750 .5000 .6250	3 to 24	3-7
 A 7X 1-... Undersize, Nominal & Oversized Diameters	303 Stainless Steel, Ground	—	.0311 to .7500	12 to 36	3-8
			.1247 .1872 .2497	1 to 16-7/8	3-9 thru 3-11
			.3122 .3747 .4997	3 to 36	3-12
 A 7C 1-...	AISI 1215 Cold Rolled Steel, Drawn	—	.1562 to .5000	6 to 36	3-13
 A 7Q 1-..	AISI 1045 Tool Steel, Ground	—	1/8 to 1	36	3-13

PATENTED
TWO-PIECE FASTENING DEVICE

PHONE: 516.328.3300 • FAX: 516.326.8827 • WWW.SDP-SI.COM



► **A SUPERIOR WAY TO FASTEN ROTATING COMPONENTS:**

Excelling because of its simplicity, it contains all structural features in only two parts. This new development is the Shaftloc® - a patented device (United States Patent No. 5,067,846), - manufactured and marketed exclusively by SDP/SI.

► **SHAFTLOC® HAS ONLY TWO PARTS:**

A slotted outer sleeve and a slotted inner sleeve, both of which have hexagonal heads. The outer sleeve is cylindrical on its outside diameter, and threaded on its inside diameter. Conversely, the inner sleeve is threaded on its outside diameter, and cylindrical on its inside diameter. The thread is unique in that it is not symmetrical and that it creates a continuous inclined surface.

Style 1
A 7Z37 - series
Double-Ended

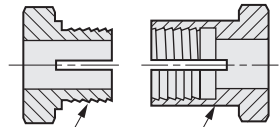

INNER SLEEVE OUTER SLEEVE

Style 2
A 7Z39M - series
Single-Ended

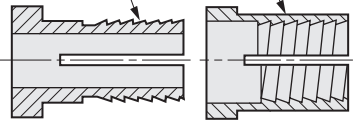

► **HOW SHAFTLOC® WORKS:**

The shallow angle of the thread produces large amplifications of forces, resulting in substantial torque transmission capability between the component and the shaft.

Style 1:

Double-Ended, when the two sleeves are threaded into each other with a component placed between them, tightening the sleeves will cause the outer one to expand and the inner one to contract.

Style 2:

Single-Ended, when the two sleeves are threaded into each other and slipped into the component, tightening the sleeves will cause the outer one to expand and the inner one to contract.

Style 1
Double-Ended

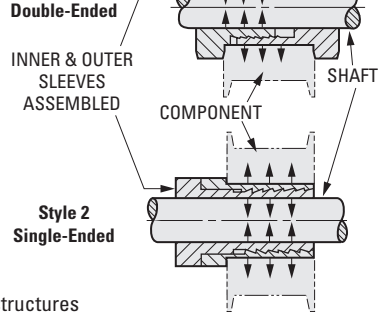

Style 2
Single-Ended

► **DISTINCT ADVANTAGES OF SHAFTLOC® OVER OTHER FASTENING DEVICES:**

- Ability to be used for stationary breadboard or production structures
- Simplicity of design - few parts
- Easy repositioning or synchronizing of rotating components
- Ease of assembly
- Applicability to small shaft diameters
- Availability in all stainless construction
- No marring of shafts
- Low cost



► **LEARN MORE ABOUT SHAFTLOC® AT:**

<http://www.sdp-si.com/products/Shaftloc-and-Accessories/index.php>

► **FOR ALL THE SHAFTLOC® FASTENERS, GO TO:**

Shaftloc® Styles	Inch Sizes	Metric Sizes
A-Type	A 7Z38-...	A 7Z38M...
M-Type	A 7Z36-...	A 7Z36M...
Double-Ended Type	A 7Z37-...	—
Single-Ended Type	A 7Z39-...	A 7Z39M...

► **FOR SHAFTLOC® PULLEYS:**

- XL: A 6T 3-H...
- L: A 6T 4-H...
- HTD 3 mm: A 6T23-H...
- HTD 5 mm: A 6T25-H...

> **MATERIAL:**

303 Stainless Steel

PHONE: 516.328.3300 • FAX: 516.326.8827 • WWW.SDP-SI.COM

> **STRAIGHTNESS:**

.0002 inches per inch

Other lengths available on special order.

Example: S4012Y-US2-09 has a diameter of .18725 and a length, L, of 1.125.

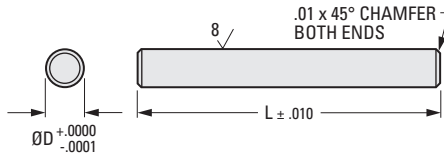

INCH COMPONENT CATALOG NUMBER

D Diameter .12475: **S4008Y-US1** -

D Diameter .18725: **S4012Y-US2** -

D Diameter .24975: **S4016Y-US3** -

Length Code

Length Code	L Length in.
08	1.000
09	1.125
10	1.250
11	1.375
12	1.500
13	1.625
14	1.750
15	1.875
16	2.000
17	2.125
18	2.250
19	2.375
20	2.500
21	2.625
22	2.750
23	2.875
24	3.000
25	3.125
26	3.250
27	3.375
28	3.500
29	3.625
30	3.750

Length Code	L Length in.
31	3.875
32	4.000
33	4.125
34	4.250
35	4.375
36	4.500
37	4.625
38	4.750
39	4.875
40	5.000
41	5.125
42	5.250
43	5.375
44	5.500
48	6.000
52	6.500
56	7.000
60	7.500
64	8.000
68	8.500
72	9.000
80	10.000

- I
- R
- T
- 1
- 2
- 3**
- 4
- 5
- 6
- 7
- 8
- 9
- 10
- 11
- 12
- 13
- 14
- 15
- A

› MATERIAL:

416 Stainless Steel Cond. T (Rc 26-32)

PHONE: 516.328.3300 • FAX: 516.326.8827 • WWW.SDP-SI.COM

› STRAIGHTNESS:

.0003 inches per inch



Grooving, other lengths and diameters available on special order.

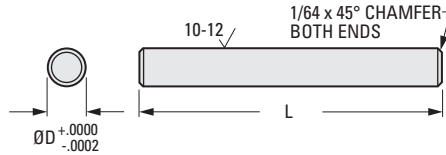

INCH COMPONENT

Catalog Number				L Length ± .010 in.
D Diameter .1247	D Diameter .1872	D Diameter .2497	D Diameter .3747	
S40PX0-HG2-008	S40PX0-HG3-008	S40PX0-HG4-008	S40PX0-HG5-008	1
S40PX0-HG2-010	S40PX0-HG3-010	S40PX0-HG4-010	S40PX0-HG5-010	1-1/4
S40PX0-HG2-012	S40PX0-HG3-012	S40PX0-HG4-012	S40PX0-HG5-012	1-1/2
S40PX0-HG2-014	S40PX0-HG3-014	S40PX0-HG4-014	S40PX0-HG5-014	1-3/4
S40PX0-HG2-016	S40PX0-HG3-016	S40PX0-HG4-016	S40PX0-HG5-016	2
S40PX0-HG2-018	S40PX0-HG3-018	S40PX0-HG4-018	S40PX0-HG5-018	2-1/4
S40PX0-HG2-020	S40PX0-HG3-020	S40PX0-HG4-020	S40PX0-HG5-020	2-1/2
S40PX0-HG2-022	S40PX0-HG3-022	S40PX0-HG4-022	S40PX0-HG5-022	2-3/4
S40PX0-HG2-024	S40PX0-HG3-024	S40PX0-HG4-024	S40PX0-HG5-024	3
S40PX0-HG2-026	S40PX0-HG3-026	S40PX0-HG4-026	S40PX0-HG5-026	3-1/4
S40PX0-HG2-028	S40PX0-HG3-028	S40PX0-HG4-028	S40PX0-HG5-028	3-1/2
S40PX0-HG2-030	S40PX0-HG3-030	S40PX0-HG4-030	S40PX0-HG5-030	3-3/4
S40PX0-HG2-032	S40PX0-HG3-032	S40PX0-HG4-032	S40PX0-HG5-032	4
S40PX0-HG2-034	S40PX0-HG3-034	S40PX0-HG4-034	S40PX0-HG5-034	4-1/4
S40PX0-HG2-036	S40PX0-HG3-036	S40PX0-HG4-036	S40PX0-HG5-036	4-1/2
S40PX0-HG2-038	S40PX0-HG3-038	S40PX0-HG4-038	S40PX0-HG5-038	4-3/4
S40PX0-HG2-040	S40PX0-HG3-040	S40PX0-HG4-040	S40PX0-HG5-040	5
S40PX0-HG2-042	S40PX0-HG3-042	S40PX0-HG4-042	S40PX0-HG5-042	5-1/4
S40PX0-HG2-044	S40PX0-HG3-044	S40PX0-HG4-044	S40PX0-HG5-044	5-1/2
S40PX0-HG2-046	S40PX0-HG3-046	S40PX0-HG4-046	S40PX0-HG5-046	5-3/4
S40PX0-HG2-048	S40PX0-HG3-048	S40PX0-HG4-048	S40PX0-HG5-048	6
S40PX0-HG2-050	S40PX0-HG3-050	S40PX0-HG4-050	S40PX0-HG5-050	6-1/4
S40PX0-HG2-052	S40PX0-HG3-052	S40PX0-HG4-052	S40PX0-HG5-052	6-1/2
S40PX0-HG2-054	S40PX0-HG3-054	S40PX0-HG4-054	S40PX0-HG5-054	6-3/4
S40PX0-HG2-056	S40PX0-HG3-056	S40PX0-HG4-056	S40PX0-HG5-056	7
S40PX0-HG2-058	S40PX0-HG3-058	S40PX0-HG4-058	S40PX0-HG5-058	7-1/4
S40PX0-HG2-060	S40PX0-HG3-060	S40PX0-HG4-060	S40PX0-HG5-060	7-1/2
S40PX0-HG2-062	S40PX0-HG3-062	S40PX0-HG4-062	S40PX0-HG5-062	7-3/4
S40PX0-HG2-064	S40PX0-HG3-064	S40PX0-HG4-064	S40PX0-HG5-064	8

Continued on the next page

> MATERIAL:

416 Stainless Steel Cond. T (Rc 26-32)

PHONE: 516.328.3300 • FAX: 516.326.8827 • WWW.SDP-SI.COM

> STRAIGHTNESS:

.0003 inches per inch

Grooving, other lengths and diameters available on special order.

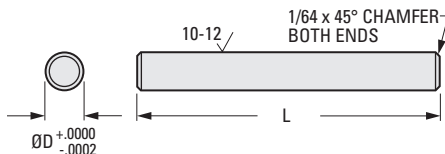
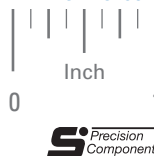

INCH COMPONENT

Catalog Number			L Length ± .010 in.
D Diameter .1247	D Diameter .1872	D Diameter .2497	
S40PX0-HG2-066	S40PX0-HG3-066	S40PX0-HG4-066	8-1/4
S40PX0-HG2-068	S40PX0-HG3-068	S40PX0-HG4-068	8-1/2
S40PX0-HG2-070	S40PX0-HG3-070	S40PX0-HG4-070	8-3/4
S40PX0-HG2-072	S40PX0-HG3-072	S40PX0-HG4-072	9
S40PX0-HG2-074	S40PX0-HG3-074	S40PX0-HG4-074	9-1/4
S40PX0-HG2-076	S40PX0-HG3-076	S40PX0-HG4-076	9-1/2
S40PX0-HG2-078	S40PX0-HG3-078	S40PX0-HG4-078	9-3/4
S40PX0-HG2-080	S40PX0-HG3-080	S40PX0-HG4-080	10
S40PX0-HG2-084	S40PX0-HG3-084	S40PX0-HG4-084	10-1/2
S40PX0-HG2-088	S40PX0-HG3-088	S40PX0-HG4-088	11
S40PX0-HG2-092	S40PX0-HG3-092	S40PX0-HG4-092	11-1/2
S40PX0-HG2-096	S40PX0-HG3-096	S40PX0-HG4-096	12
S40PX0-HG2-100	S40PX0-HG3-100	S40PX0-HG4-100	12-1/2
S40PX0-HG2-104	S40PX0-HG3-104	S40PX0-HG4-104	13
S40PX0-HG2-112	S40PX0-HG3-112	S40PX0-HG4-112	14
S40PX0-HG2-120	S40PX0-HG3-120	S40PX0-HG4-120	15
S40PX0-HG2-128	S40PX0-HG3-128	S40PX0-HG4-128	16
S40PX0-HG2-192	S40PX0-HG3-192	S40PX0-HG4-192	24

Continued from the previous page

› MATERIAL:

Steel AISI C1060, Case Hardened to Rc 60-63

PHONE: 516.328.3300 • FAX: 516.326.8827 • WWW.SDP-SI.COM

› STRAIGHTNESS:

.0001 inches per inch

› SPECIFICATIONS:

Minimum Depth of Hardness:

.031" for 1/4" & 3/8" diameters

.051" for 1/2" & 3/4" diameters

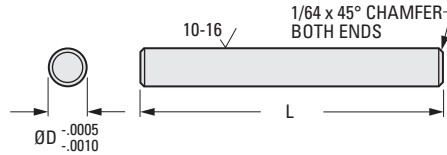

INCH COMPONENT

Catalog Number			L Length ± 1/32 in.
D Diameter .2500	D Diameter .3750	D Diameter .5000	
S40PH0-CHS2-006	S40PH0-CHS3-006	S40PH0-CHS4-006	3
S40PH0-CHS2-007	S40PH0-CHS3-007	S40PH0-CHS4-007	3-1/2
S40PH0-CHS2-008	S40PH0-CHS3-008	S40PH0-CHS4-008	4
S40PH0-CHS2-009	S40PH0-CHS3-009	S40PH0-CHS4-009	4-1/2
S40PH0-CHS2-010	S40PH0-CHS3-010	S40PH0-CHS4-010	5
S40PH0-CHS2-011	S40PH0-CHS3-011	S40PH0-CHS4-011	5-1/2
S40PH0-CHS2-012	S40PH0-CHS3-012	S40PH0-CHS4-012	6
S40PH0-CHS2-013	S40PH0-CHS3-013	S40PH0-CHS4-013	6-1/2
S40PH0-CHS2-014	S40PH0-CHS3-014	S40PH0-CHS4-014	7
S40PH0-CHS2-015	S40PH0-CHS3-015	S40PH0-CHS4-015	7-1/2
S40PH0-CHS2-016	S40PH0-CHS3-016	S40PH0-CHS4-016	8
S40PH0-CHS2-017	S40PH0-CHS3-017	S40PH0-CHS4-017	8-1/2
S40PH0-CHS2-018	S40PH0-CHS3-018	S40PH0-CHS4-018	9
S40PH0-CHS2-019	S40PH0-CHS3-019	S40PH0-CHS4-019	9-1/2
S40PH0-CHS2-020	S40PH0-CHS3-020	S40PH0-CHS4-020	10
S40PH0-CHS2-022	S40PH0-CHS3-022	S40PH0-CHS4-022	11
S40PH0-CHS2-024	S40PH0-CHS3-024	S40PH0-CHS4-024	12
S40PH0-CHS2-026	S40PH0-CHS3-026	S40PH0-CHS4-026	13
S40PH0-CHS2-028	S40PH0-CHS3-028	S40PH0-CHS4-028	14
S40PH0-CHS2-030	S40PH0-CHS3-030	S40PH0-CHS4-030	15
S40PH0-CHS2-032	S40PH0-CHS3-032	S40PH0-CHS4-032	16
S40PH0-CHS2-034	S40PH0-CHS3-034	S40PH0-CHS4-034	17
S40PH0-CHS2-036	S40PH0-CHS3-036	S40PH0-CHS4-036	18
S40PH0-CHS2-038	S40PH0-CHS3-038	S40PH0-CHS4-038	19
S40PH0-CHS2-040	S40PH0-CHS3-040	S40PH0-CHS4-040	20
S40PH0-CHS2-044	S40PH0-CHS3-044	S40PH0-CHS4-044	22
S40PH0-CHS2-048	S40PH0-CHS3-048	S40PH0-CHS4-048	24
S40PH0-CHS2-052	S40PH0-CHS3-052	S40PH0-CHS4-052	26
S40PH0-CHS2-056	S40PH0-CHS3-056	S40PH0-CHS4-056	28
S40PH0-CHS2-060	S40PH0-CHS3-060	S40PH0-CHS4-060	30
S40PH0-CHS2-064	S40PH0-CHS3-064	S40PH0-CHS4-064	32
S40PH0-CHS2-068	S40PH0-CHS3-068	S40PH0-CHS4-068	34
S40PH0-CHS2-072	S40PH0-CHS3-072	S40PH0-CHS4-072	36

HARDENED PRECISION GROUND SHAFTING



> MATERIAL:

420 Stainless Steel, Case Hardened to Rc 52-56

PHONE: 516.328.3300 • FAX: 516.326.8827 • WWW.SDP-SI.COM

> STRAIGHTNESS:

.0001 inches per inch

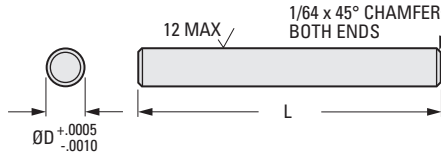
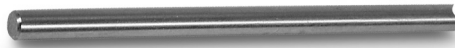
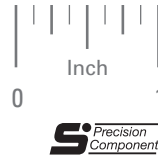

INCH COMPONENT			
Catalog Number			L Length ± 1/32 in.
D Diameter .3750	D Diameter .5000	D Diameter .6250	
S40PX0-CHS3-006	S40PX0-CHS4-006	S40PX0-CHS5-006	3
S40PX0-CHS3-007	S40PX0-CHS4-007	S40PX0-CHS5-007	3-1/2
S40PX0-CHS3-008	S40PX0-CHS4-008	S40PX0-CHS5-008	4
S40PX0-CHS3-009	S40PX0-CHS4-009	S40PX0-CHS5-009	4-1/2
S40PX0-CHS3-010	S40PX0-CHS4-010	S40PX0-CHS5-010	5
S40PX0-CHS3-011	S40PX0-CHS4-011	S40PX0-CHS5-011	5-1/2
S40PX0-CHS3-012	S40PX0-CHS4-012	S40PX0-CHS5-012	6
S40PX0-CHS3-013	S40PX0-CHS4-013	S40PX0-CHS5-013	6-1/2
S40PX0-CHS3-014	S40PX0-CHS4-014	S40PX0-CHS5-014	7
S40PX0-CHS3-015	S40PX0-CHS4-015	S40PX0-CHS5-015	7-1/2
S40PX0-CHS3-016	S40PX0-CHS4-016	S40PX0-CHS5-016	8
S40PX0-CHS3-017	S40PX0-CHS4-017	S40PX0-CHS5-017	8-1/2
S40PX0-CHS3-018	S40PX0-CHS4-018	S40PX0-CHS5-018	9
S40PX0-CHS3-019	S40PX0-CHS4-019	S40PX0-CHS5-019	9-1/2
S40PX0-CHS3-020	S40PX0-CHS4-020	S40PX0-CHS5-020	10
S40PX0-CHS3-022	S40PX0-CHS4-022	S40PX0-CHS5-022	11
S40PX0-CHS3-024	S40PX0-CHS4-024	S40PX0-CHS5-024	12
S40PX0-CHS3-026	S40PX0-CHS4-026	S40PX0-CHS5-026	13
S40PX0-CHS3-028	S40PX0-CHS4-028	S40PX0-CHS5-028	14
S40PX0-CHS3-030	S40PX0-CHS4-030	S40PX0-CHS5-030	15
S40PX0-CHS3-032	S40PX0-CHS4-032	S40PX0-CHS5-032	16
S40PX0-CHS3-034	S40PX0-CHS4-034	S40PX0-CHS5-034	17
S40PX0-CHS3-036	S40PX0-CHS4-036	S40PX0-CHS5-036	18
S40PX0-CHS3-038	S40PX0-CHS4-038	S40PX0-CHS5-038	19
S40PX0-CHS3-040	S40PX0-CHS4-040	S40PX0-CHS5-040	20
S40PX0-CHS3-044	S40PX0-CHS4-044	S40PX0-CHS5-044	22
S40PX0-CHS3-048	S40PX0-CHS4-048	S40PX0-CHS5-048	24

- I
- R
- T
- 1
- 2
- 3**
- 4
- 5
- 6
- 7
- 8
- 9
- 10
- 11
- 12
- 13
- 14
- 15
- A

UNDERSIZE, NOMINAL AND OVERSIZE
DIAMETERS

PHONE: 516.328.3300 • FAX: 516.326.8827 • WWW.SDP-SI.COM



MATERIAL:

303 Stainless Steel

Other lengths and diameters available on special order.

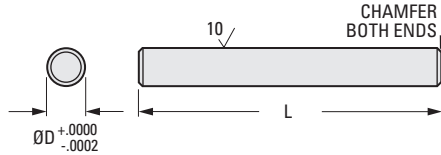

INCH COMPONENT

Catalog Number	D Diameter +.0000 -.0002	L Length ± .125 in.
A 7X 1-0112B	.0311	12
A 7X 1-0112	.0313	
A 7X 1-0112A	.0317	
A 7X 1-0212	.0622	
A 7X 1-0212A	.0626	
A 7X 1-0212B	.0630	
A 7X 1-0312	.0778	
A 7X 1-0312A	.0781	
A 7X 1-0312B	.0786	
A 7X 1-0312C	.0934	
A 7X 1-0312F	.0935	
A 7X 1-0312D	.0938	
A 7X 1-0312E	.0942	
A 7X 1-0424	.1247	24
A 7X 1-0424A	.1250	
A 7X 1-0424B	.1252	
A 7X 1-0424C	.1255	
A 7X 1-0524	.1560	
A 7X 1-0524A	.1562	
A 7X 1-0524B	.1567	
A 7X 1-0624	.1872	
A 7X 1-0624A	.1875	
A 7X 1-0624B	.1877	
A 7X 1-0724	.2184	
A 7X 1-0724A	.2187	
A 7X 1-0724B	.2192	

Catalog Number	D Diameter +.0000 -.0002	L Length ± .125 in.
A 7X 1-0824	.2497	24
A 7X 1-0836		36
A 7X 1-0824A	.2500	24
A 7X 1-0836A		36
A 7X 1-0824B	.2502	24
A 7X 1-0836B	.2505	36
A 7X 1-1024	.3122	24
A 7X 1-1016	.3123	16
A 7X 1-1016A	.3125	
A 7X 1-1024A	.3127	24
A 7X 1-1016B	.3127	16
A 7X 1-1024B	.3130	24
A 7X 1-1216	.3747	16
A 7X 1-1236		36
A 7X 1-1216A	.3750	16
A 7X 1-1236A	.3752	36
A 7X 1-1216B	.3752	16
A 7X 1-1236B	.3755	36
A 7X 1-1616	.4997	16
A 7X 1-1636		36
A 7X 1-1612A	.5000	12
A 7X 1-1616A	.5000	16
A 7X 1-1636A	.5002	36
A 7X 1-1616B	.5002	16
A 7X 1-1636B	.5005	36
A 7X 1-2412A	.7500	12

UNDERSIZE DIAMETERS

PHONE: 516.328.3300 • FAX: 516.326.8827 • WWW.SDP-SI.COM

> MATERIAL:

303 Stainless Steel

> STRAIGHTNESS:

.0004 inches per inch

Grooving, other modifications and sizes available on special order.

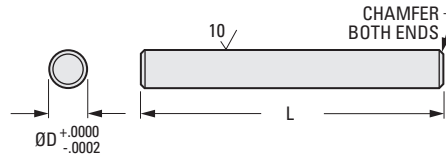
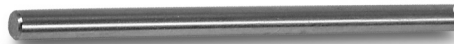

INCH COMPONENT			
Catalog Number			L Length ± .010 in.
D Diameter .1247	D Diameter .1872	D Diameter .2497	
A 7X 1-04010	A 7X 1-06010	A 7X 1-08010	1
A 7X 1-04011	A 7X 1-06011	A 7X 1-08011	1-1/8
A 7X 1-04012	A 7X 1-06012	A 7X 1-08012	1-1/4
A 7X 1-04013	A 7X 1-06013	A 7X 1-08013	1-3/8
A 7X 1-04015	A 7X 1-06015	A 7X 1-08015	1-1/2
A 7X 1-04016	A 7X 1-06016	A 7X 1-08016	1-5/8
A 7X 1-04017	A 7X 1-06017	A 7X 1-08017	1-3/4
A 7X 1-04018	A 7X 1-06018	A 7X 1-08018	1-7/8
A 7X 1-04020	A 7X 1-06020	A 7X 1-08020	2
A 7X 1-04021	A 7X 1-06021	A 7X 1-08021	2-1/8
A 7X 1-04022	A 7X 1-06022	A 7X 1-08022	2-1/4
A 7X 1-04023	A 7X 1-06023	A 7X 1-08023	2-3/8
A 7X 1-04025	A 7X 1-06025	A 7X 1-08025	2-1/2
A 7X 1-04026	A 7X 1-06026	A 7X 1-08026	2-5/8
A 7X 1-04027	A 7X 1-06027	A 7X 1-08027	2-3/4
A 7X 1-04028	A 7X 1-06028	A 7X 1-08028	2-7/8
A 7X 1-04030	A 7X 1-06030	A 7X 1-08030	3
A 7X 1-04031	A 7X 1-06031	A 7X 1-08031	3-1/8
A 7X 1-04032	A 7X 1-06032	A 7X 1-08032	3-1/4
A 7X 1-04033	A 7X 1-06033	A 7X 1-08033	3-3/8
A 7X 1-04035	A 7X 1-06035	A 7X 1-08035	3-1/2
A 7X 1-04036	A 7X 1-06036	A 7X 1-08036	3-5/8
A 7X 1-04037	A 7X 1-06037	A 7X 1-08037	3-3/4
A 7X 1-04038	A 7X 1-06038	A 7X 1-08038	3-7/8
A 7X 1-04040	A 7X 1-06040	A 7X 1-08040	4
A 7X 1-04041	A 7X 1-06041	A 7X 1-08041	4-1/8
A 7X 1-04042	A 7X 1-06042	A 7X 1-08042	4-1/4
A 7X 1-04043	A 7X 1-06043	A 7X 1-08043	4-3/8
A 7X 1-04045	A 7X 1-06045	A 7X 1-08045	4-1/2
A 7X 1-04046	A 7X 1-06046	A 7X 1-08046	4-5/8
A 7X 1-04047	A 7X 1-06047	A 7X 1-08047	4-3/4
A 7X 1-04048	A 7X 1-06048	A 7X 1-08048	4-7/8

Continued on the next page



UNDERSIZE DIAMETERS

PHONE: 516.328.3300 • FAX: 516.326.8827 • WWW.SDP-SI.COM

► **MATERIAL:**

303 Stainless Steel

► **STRAIGHTNESS:**

.0004 inches per inch

Grooving, other modifications and sizes available on special order.

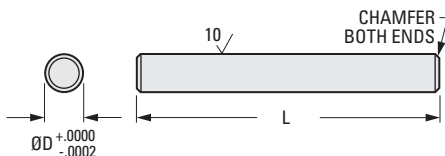

INCH COMPONENT			
Catalog Number			L Length ± .010 in.
D Diameter .1247	D Diameter .1872	D Diameter .2497	
A 7X 1-04050	A 7X 1-06050	A 7X 1-08050	5
A 7X 1-04051	A 7X 1-06051	A 7X 1-08051	5-1/8
A 7X 1-04052	A 7X 1-06052	A 7X 1-08052	5-1/4
A 7X 1-04053	A 7X 1-06053	A 7X 1-08053	5-3/8
A 7X 1-04055	A 7X 1-06055	A 7X 1-08055	5-1/2
A 7X 1-04056	—	A 7X 1-08056	5-5/8
A 7X 1-04057	—	A 7X 1-08057	5-3/4
A 7X 1-04058	A 7X 1-06058	—	5-7/8
A 7X 1-04060	A 7X 1-06060	A 7X 1-08060	6
—	—	A 7X 1-08061	6-1/8
—	—	A 7X 1-08062	6-1/4
—	A 7X 1-06063	A 7X 1-08063	6-3/8
A 7X 1-04065	A 7X 1-06065	A 7X 1-08065	6-1/2
A 7X 1-04066	—	—	6-5/8
—	—	A 7X 1-08067	6-3/4
A 7X 1-04070	A 7X 1-06070	A 7X 1-08070	7
—	—	A 7X 1-08071	7-1/8
—	—	A 7X 1-08072	7-1/4
—	—	A 7X 1-08073	7-3/8
—	—	A 7X 1-08075	7-1/2
—	—	A 7X 1-08076	7-5/8
—	—	A 7X 1-08077	7-3/4
A 7X 1-04080	A 7X 1-06080	A 7X 1-08080	8
—	—	A 7X 1-08081	8-1/8
—	—	A 7X 1-08082	8-1/4
—	—	A 7X 1-08083	8-3/8
—	—	A 7X 1-08085	8-1/2
—	—	A 7X 1-08088	8-7/8
A 7X 1-04090	—	—	9
A 7X 1-04091	—	—	9-1/8
A 7X 1-04092	A 7X 1-06092	—	9-1/4
—	—	A 7X 1-08093	9-3/8

Continued from the previous page
and continued on the next page

UNDERSIZE DIAMETERS

PHONE: 516.328.3300 • FAX: 516.326.8827 • WWW.SDP-SI.COM

> MATERIAL:

303 Stainless Steel

> STRAIGHTNESS:

.0004 inches per inch

Grooving, other modifications and sizes available on special order.

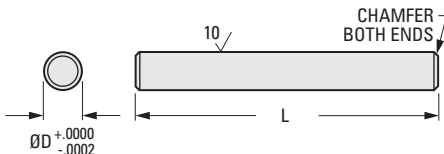
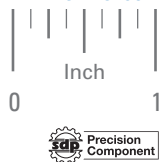

INCH COMPONENT

Catalog Number			L Length ± .010 in.
D Diameter .1247	D Diameter .1872	D Diameter .2497	
—	—	A 7X 1-08095	9-1/2
A 7X 1-04100	A 7X 1-06100	A 7X 1-08100	10
—	A 7X 1-06103	—	10-3/8
—	A 7X 1-06105	—	10-1/2
A 7X 1-04110	A 7X 1-06110	A 7X 1-08110	11
—	—	A 7X 1-08115	11-1/2
—	—	A 7X 1-08117	11-3/4
A 7X 1-04118	—	A 7X 1-08118	11-7/8
A 7X 1-04120	A 7X 1-06120	A 7X 1-08120	12
—	—	A 7X 1-08122	12-1/4
—	—	A 7X 1-08123	12-3/8
A 7X 1-04125	—	A 7X 1-08125	12-1/2
—	—	A 7X 1-08126	12-5/8
A 7X 1-04127	—	—	12-3/4
—	—	A 7X 1-08128	12-7/8
—	—	A 7X 1-08130	13
—	A 7X 1-06131	A 7X 1-08131	13-1/8
—	—	A 7X 1-08132	13-1/4
—	—	A 7X 1-08135	13-1/2
A 7X 1-04140	A 7X 1-06140	A 7X 1-08140	14
—	—	A 7X 1-08141	14-1/8
—	—	A 7X 1-08142	14-1/4
—	A 7X 1-06143	—	14-3/8
—	A 7X 1-06145	A 7X 1-08145	14-1/2
A 7X 1-04150	A 7X 1-06150	A 7X 1-08150	15
A 7X 1-04160	A 7X 1-06160	A 7X 1-08160	16
A 7X 1-04161	A 7X 1-06161	—	16-1/8
—	A 7X 1-06162	—	16-1/4
—	A 7X 1-06165	A 7X 1-08165	16-1/2
—	A 7X 1-06167	A 7X 1-08167	16-3/4
—	A 7X 1-06168	A 7X 1-08168	16-7/8

Continued from the previous page

UNDERSIZE DIAMETERS

PHONE: 516.328.3300 • FAX: 516.326.8827 • WWW.SDP-SI.COM

> MATERIAL:
303 Stainless Steel

> STRAIGHTNESS:
.0004 inches per inch

Grooving, other modifications and sizes available on special order.

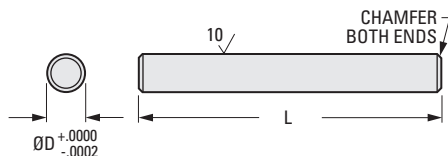

INCH COMPONENT			
Catalog Number			L Length ± .010 in.
D Diameter .3122	D Diameter .3747	D Diameter .4997	
A 7X 1-10030	A 7X 1-12030	A 7X 1-16030	3
A 7X 1-10035	A 7X 1-12035	A 7X 1-16035	3-1/2
A 7X 1-10040	A 7X 1-12040	A 7X 1-16040	4
A 7X 1-10045	A 7X 1-12045	A 7X 1-16045	4-1/2
A 7X 1-10050	A 7X 1-12050	A 7X 1-16050	5
A 7X 1-10055	A 7X 1-12055	A 7X 1-16055	5-1/2
A 7X 1-10060	A 7X 1-12060	A 7X 1-16060	6
A 7X 1-10065	A 7X 1-12065	A 7X 1-16065	6-1/2
A 7X 1-10070	A 7X 1-12070	A 7X 1-16070	7
A 7X 1-10075	A 7X 1-12075	A 7X 1-16075	7-1/2
A 7X 1-10080	A 7X 1-12080	A 7X 1-16080	8
A 7X 1-10085	A 7X 1-12085	A 7X 1-16085	8-1/2
A 7X 1-10090	A 7X 1-12090	A 7X 1-16090	9
A 7X 1-10095	A 7X 1-12095	A 7X 1-16095	9-1/2
A 7X 1-10100	A 7X 1-12100	A 7X 1-16100	10
A 7X 1-10120	A 7X 1-12120	A 7X 1-16120	12
A 7X 1-10140	A 7X 1-12140	A 7X 1-16140	14
A 7X 1-10160	A 7X 1-12160	A 7X 1-16160	16
A 7X 1-10180	A 7X 1-12180	A 7X 1-16180	18
A 7X 1-10200	A 7X 1-12200	A 7X 1-16200	20
A 7X 1-10220	A 7X 1-12220	A 7X 1-16220	22
A 7X 1-10240	A 7X 1-12240	A 7X 1-16240	24
A 7X 1-10260	A 7X 1-12260	A 7X 1-16260	26
A 7X 1-10280	A 7X 1-12280	A 7X 1-16280	28
A 7X 1-10300	A 7X 1-12300	A 7X 1-16300	30
A 7X 1-10320	A 7X 1-12320	A 7X 1-16320	32
A 7X 1-10340	A 7X 1-12340	A 7X 1-16340	34
A 7X 1-10360	A 7X 1-12360	A 7X 1-16360	36

SHAFTING

PHONE: 516.328.3300 • FAX: 516.326.8827 • WWW.SDP-SI.COM

DRAWN
SMOOTH FINISH

> MATERIAL:

AISI 1215 Cold Rolled Steel

Other lengths available on special order.

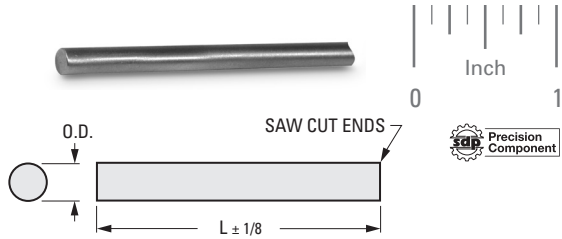

INCH COMPONENT

Catalog Number	O.D. ± .0005	L Length in.
A 7C 1-0506	.1562	6
A 7C 1-0512		12
A 7C 1-0524		24
A 7C 1-0536		36
A 7C 1-0606	.1875	6
A 7C 1-0612		12
A 7C 1-0624		24
A 7C 1-0636		36
A 7C 1-0806	.2500	6
A 7C 1-0812		12
A 7C 1-0824		24
A 7C 1-0836		36
A 7C 1-1006	.3125	6
A 7C 1-1012		12

Catalog Number	O.D. ± .0005	L Length in.
A 7C 1-1024	.3125	24
A 7C 1-1036		36
A 7C 1-1206		6
A 7C 1-1212	.3750	12
A 7C 1-1224		24
A 7C 1-1236		36
A 7C 1-1406	.4375	6
A 7C 1-1412		12
A 7C 1-1424		24
A 7C 1-1436	.5000	36
A 7C 1-1606		6
A 7C 1-1612		12
A 7C 1-1624	24	
A 7C 1-1636	36	

DRILL RODS

PRECISION

> MATERIAL:

Tool Steel - AISI 1045

> FINISH:

Ground

> SPECIFICATION:

O.D. Tolerance:
from .125 to .499 is ± .0005
from .500 to 1" is ± .001

Oil-hardened high-quality tool steel is suitable for punches, dies & high-strength machined parts.

Sold in 3 ft. lengths only.

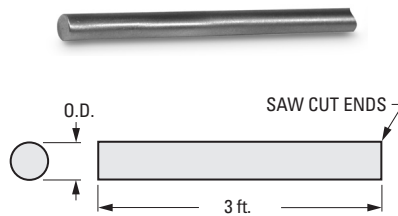

INCH COMPONENT

Catalog Number	O.D.
A 7Q 1-04	1/8
A 7Q 1-05	5/32
A 7Q 1-06	3/16
A 7Q 1-08	1/4
A 7Q 1-09	9/32
A 7Q 1-10	5/16
A 7Q 1-11	11/32

Catalog Number	O.D.
A 7Q 1-12	3/8
A 7Q 1-14	7/16
A 7Q 1-16	1/2
A 7Q 1-20	5/8
A 7Q 1-24	3/4
A 7Q 1-28	7/8
A 7Q 1-32	1