

FOR BELTS UP TO 1/4" WIDE
DOUBLE OR NO FLANGE

PHONE: 516.328.3300 • FAX: 516.326.8827 • WWW.SDP-SI.COM

► MATERIAL:

Aluminum Alloy

► FINISH:

Clear Anodized

► SPECIFICATIONS:

O.D. Tolerance:

10 to 40 grooves is $+.002/-0.000$

42 to 72 grooves is $+.003/-0.000$

80 to 120 grooves is $+.004/-0.000$

Pulleys with 10 to 16 grooves
have 1 set screw; others
have 2 at 90°.

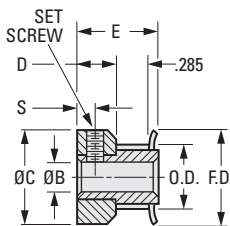

Fig. 1

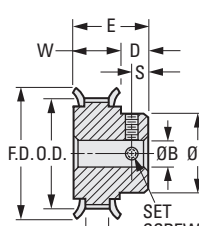

Fig. 2

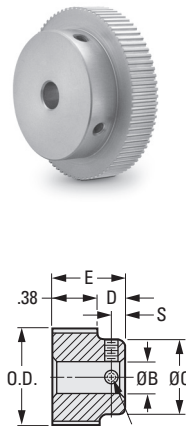

Fig. 3

INCH COMPONENT

Catalog Number	Fig. No.	No. of Grooves	P.D.	O.D.	F.D. ± 1/64	B Bore +.001 -.000	W Body	E Lgth. ± 1/64	C Hub Dia. ± 1/64	D Hub Proj.	S	Set Screw
Double Flange												
A 6A16-010DF2504	1	10	.255	.235	.425	.1250	—	9/16	.425	15/64	7/64	#4-40
A 6A16-011DF2504	1	11	.280	.260	.450	.1250	—	9/16	.450	15/64	7/64	#4-40
A 6A16-012DF2504	1	12	.306	.286	.480	.1250	—	9/16	.480	15/64	7/64	#4-40
A 6A16-014DF2504	1	14	.357	.337	.530	.1250	—	9/16	.530	15/64	7/64	#4-40
A 6A16-014DF2505	1	14	.357	.337	.530	.1565	—	9/16	.530	15/64	7/64	#4-40
A 6A16-015DF2506	1	15	.382	.362	.555	.1875	—	9/16	.555	15/64	7/64	#6-40
A 6A16-016DF2506	1	16	.407	.387	.580	.1875	—	9/16	.580	15/64	7/64	#6-40
A 6A16-018DF2506	2	18	.458	.438	.635	.1875	.389	5/8	.312	15/64	7/64	#6-40
A 6A16-018DF2508	1	18	.458	.438	.635	.2500	—	9/16	.635	15/64	7/64	#6-40
A 6A16-020DF2506	2	20	.509	.489	.685	.1875	.389	5/8	.364	15/64	7/64	#6-40
A 6A16-020DF2508	1	20	.509	.489	.685	.2500	—	9/16	.685	15/64	7/64	#6-40
A 6A16-021DF2506	2	21	.535	.515	.710	.1875	.389	5/8	.390	15/64	7/64	#6-40
A 6A16-021DF2508	1	21	.535	.515	.710	.2500	—	9/16	.710	15/64	7/64	#6-40
A 6A16-022DF2506	2	22	.560	.540	.740	.1875	.389	5/8	.390	15/64	7/64	#6-40
A 6A16-022DF2508	1	22	.560	.540	.740	.2500	—	9/16	.740	19/64	7/64	#6-40
A 6A16-024DF2508	2	24	.611	.591	.790	.2500	.389	11/16	.442	19/64	5/32	#6-40
A 6A16-025DF2508	2	25	.637	.617	.815	.2500	.389	11/16	.468	19/64	5/32	#6-40
A 6A16-028DF2508	2	28	.713	.693	.895	.2500	.389	11/16	.494	19/64	5/32	#6-40
A 6A16-030DF2508	2	30	.764	.744	.945	.2500	.389	11/16	.546	19/64	5/32	#8-32
A 6A16-032DF2508	2	32	.815	.795	1.000	.2500	.389	11/16	.598	19/64	5/32	#8-32
A 6A16-036DF2508	2	36	.917	.897	1.105	.2500	.389	11/16	.676	19/64	5/32	#8-32
A 6A16-040DF2508	2	40	1.019	.999	1.210	.2500	.405	23/32	.754	5/16	5/32	#8-32
A 6A16-042DF2508	2	42	1.070	1.050	1.260	.2500	.405	23/32	.806	5/16	5/32	#8-32
A 6A16-044DF2508	2	44	1.120	1.100	1.315	.2500	.405	23/32	.858	5/16	5/32	#8-32
A 6A16-048DF2508	2	48	1.222	1.202	1.420	.2500	.405	23/32	.936	5/16	5/32	#8-32
A 6A16-060DF2508	2	60	1.528	1.508	1.730	.2500	.405	23/32	1.222	5/16	5/32	#8-32
No Flange												
A 6A16-060NF2508	3	60	1.528	1.508	—	.2500	—	3/4	1.148	3/8	3/16	#8-32
A 6A16-072NF2508	3	72	1.833	1.813	—	.2500	—	3/4	1.195	3/8	3/16	#8-32
A 6A16-080NF2510	3	80	2.037	2.017	—	.3125	—	3/4	1.500	3/8	3/16	#8-32
A 6A16-090NF2510	3	90	2.292	2.272	—	.3125	—	3/4	1.500	3/8	3/16	#8-32
A 6A16-100NF2510	3	100	2.546	2.526	—	.3125	—	3/4	1.500	3/8	3/16	#8-32
A 6A16-120NF2512	3	120	3.056	3.036	—	.3750	—	3/4	1.500	3/8	3/16	#10-32