

S¹ INCH**Clamp Type Spur Gears - 64 Pitch**

■ AGMA Q10

■ 20° PRESSURE ANGLE

■ 1/8 FACE

■ 1/8 BORE

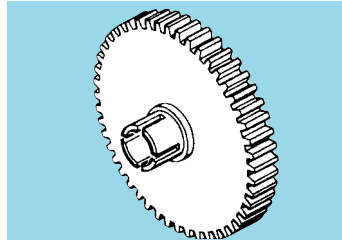
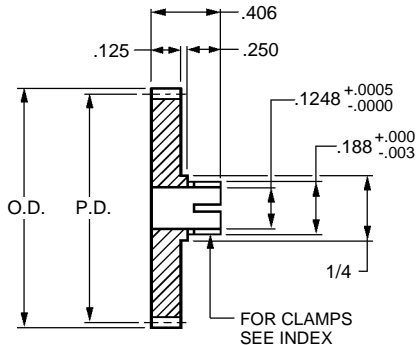
**S¹ Precision Component**

Catalog Number		No. of Teeth	P.D.	O.D.
303 Stainless Steel	2024 Aluminum * Anodized			
S1163Z-064S018	S1163Z-064A018	18	0.2813	0.313
S1163Z-064S021	S1163Z-064A021	21	0.3281	0.359
S1163Z-064S022	S1163Z-064A022	22	0.3438	0.375
S1163Z-064S024	S1163Z-064A024	24	0.3750	0.406
S1163Z-064S025	S1163Z-064A025	25	0.3906	0.422
S1163Z-064S028	S1163Z-064A028	28	0.4375	0.469
S1163Z-064S030	S1163Z-064A030	30	0.4688	0.500
S1163Z-064S032	S1163Z-064A032	32	0.5000	0.531
S1163Z-064S034	S1163Z-064A034	34	0.5313	0.563
S1163Z-064S036	S1163Z-064A036	36	0.5625	0.594
S1163Z-064S038	S1163Z-064A038	38	0.5938	0.625
S1163Z-064S040	S1163Z-064A040	40	0.6250	0.656
S1163Z-064S044	S1163Z-064A044	44	0.6875	0.719
S1163Z-064S046	S1163Z-064A046	46	0.7188	0.750
S1163Z-064S048	S1163Z-064A048	48	0.7500	0.781
S1163Z-064S050	S1163Z-064A050	50	0.7813	0.813
S1163Z-064S055	S1163Z-064A055	55	0.8594	0.891
S1163Z-064S056	S1163Z-064A056	56	0.8750	0.906
S1163Z-064S060	S1163Z-064A060	60	0.9375	0.969
S1163Z-064S064	S1163Z-064A064	64	1.0000	1.031
S1163Z-064S070	S1163Z-064A070	70	1.0938	1.125
S1163Z-064S072	S1163Z-064A072	72	1.1250	1.156
S1163Z-064S080	S1163Z-064A080	80	1.2500	1.281
S1163Z-064S084	S1163Z-064A084	84	1.3125	1.344
S1163Z-064S090	S1163Z-064A090	90	1.4063	1.438
S1163Z-064S096	S1163Z-064A096	96	1.5000	1.531
S1163Z-064S112	S1163Z-064A112	112	1.7500	1.781
S1163Z-064S120	S1163Z-064A120	120	1.8750	1.906
S1163Z-064S128	S1163Z-064A128	128	2.0000	2.031
S1163Z-064S136	S1163Z-064A136	136	2.1250	2.156

* T4 or T351 Aluminum Alloy, anodized before cutting.

Available on special order : 14-1/2° P.A., teeth not listed, different bore size and/or material, passivation for stainless steel.