

SPHERICAL BEARINGS • PRESS FIT

SDP/SI

FOR SHAFT DIAMETERS: 2 mm - 12 mm
 SELF ALIGNING
 EASY TO INSTALL
 LOW COST

PHONE: 516.328.3300 • FAX: 516.326.8827 • WWW.SDP-SI.COM



> MATERIAL:

Housing - igumid G
 Ball - L280 Polymer

> OPERATING TEMPERATURE:

-30°C to +80°C

> FEATURES:

Maintenance free
 Chemical and UV resistant
 Lightweight
 Durable

> SPECIFICATIONS:

I.D. After Press Fit:
 2 mm & 3 mm +0.054/+0.014
 5 mm & 6 mm +0.068/+0.020
 8 mm & 10 mm +0.083/+0.025
 12 mm +0.102/+0.032

For optimal performance adhere to the specifications for housing bores (H7) and recommended shaft sizes (h7). Press fit bearings are meant to be oversized before being press fit. After proper installation into a recommended housing bore, the inner diameter adjusts to meet our specified tolerances.

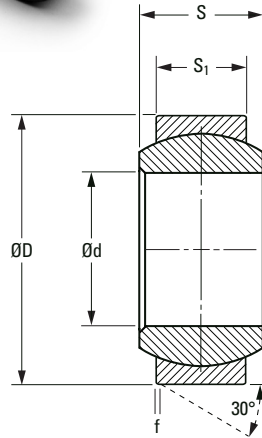

METRIC COMPONENT

Catalog Number	d I.D.	D	Width		Max. Pivot Angle	Max. Torque through the ball Nm
			s	S ₁		
S99GSBM020804	2	8	4	3	32°	1
S99GSBM031006	3	10	6	4.5		2
S99GSBM051308	5	13	8	6	30°	5
S99GSBM061609	6	16	9	6.5	29°	10
S99GSBM081912	8	19	12	9		12
S99GSBM102214	10	22	14	10.5	25°	20
S99GSBM122616	12	26	16	12		30

METRIC COMPONENT

Catalog Number (Ref.)	Max. Static Load		Housing Bore		Shaft Size		f	Weight g
	Radial N	Axial N	Max.	Min.	Max.	Min.		
S99GSBM020804	300	60	8.015	8.000	2.000	1.990	0.8	0.1
S99GSBM031006	550	200	10.015	10.000	3.000	2.990		0.5
S99GSBM051308	1300	500	13.018	13.000	5.000	4.980		1
S99GSBM061609	1800	650	16.018	16.000	6.000	5.980		1.6
S99GSBM081912	2700	1200	19.021	19.000	8.000	7.985		2.9
S99GSBM102214	4000	1400	22.021	22.000	10.000	9.985		4.4
S99GSBM122616	5400	1500	26.021	26.000	12.000	11.982		7

NOTE: For housing bores: H7
 For shaft sizes: h7

??-??

SPHERICAL BEARINGS • PRESS FIT

SDP/SI

FOR SHAFT DIAMETERS: 4 mm - 12 mm
 SELF ALIGNING
 EASY TO INSTALL
 LOW COST

PHONE: 516.328.3300 • FAX: 516.326.8827 • WWW.SDP-SI.COM



> MATERIAL:

Housing - igumid G
Ball - L280 Polymer

> OPERATING TEMPERATURE:

-30°C to +80°C

> FEATURES:

Maintenance free
 Chemical and UV resistant
 Lightweight
 Durable

> SPECIFICATIONS:

I.D. After Press Fit:
 4 mm to 6 mm +0.068/+0.020
 8 mm & 10 mm +0.083/+0.025
 12 mm +0.102/+0.032

For optimal performance adhere to the specifications for housing bores (H7) and recommended shaft sizes (h7). Press fit bearings are meant to be oversized before being press fit. After proper installation into a recommended housing bore, the inner diameter adjusts to meet our specified tolerances.

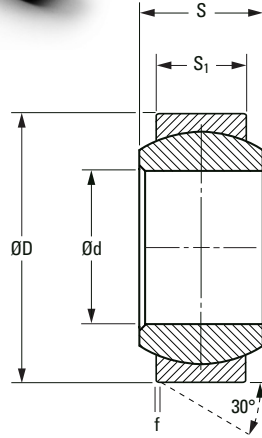

METRIC COMPONENT

Catalog Number	d I.D.	D	Width		Max. Pivot Angle	Max. Torque through the ball Nm
			s	S ₁		
S99GSBM041205	4	12	5	3	37°	2
S99GSBM051406	5	14	6	4	33°	
S99GSBM061406	6		8	5	27°	2.4
S99GSBM081608	8	16	8	5	24°	7
S99GSBM101909	10	19	9	6		14
S99GSBM122210	12	22	10	7	21°	25

METRIC COMPONENT

Catalog Number (Ref.)	Max. Static Load		Housing Bore		Shaft Size		f	Weight g
	Radial N	Axial* N	Max.	Min.	Max.	Min.		
S99GSBM041205	600	50	12.018	12.000	4.000	3.980	0.5	0.4
S99GSBM051406	1000	130	14.018	14.000	5.000	4.980		0.8
S99GSBM061406	1200	150			6.000	5.980		0.9
S99GSBM081608	1800	175	16.018	16.000	8.000	7.985		1.2
S99GSBM101909	2500	400	19.021	19.000	10.000	9.985		1.9
S99GSBM122210	3800	650	22.021	22.000	12.000	11.982		1.9
								2.8

*Maximum Static Axial Load is determined in a remote location hole.

NOTE: For housing bores: H7
 For shaft sizes: h7

??-??